

HabasitLINK® Accessories – 2" Pitch Belting

Hold Down Devices for M5000

For elevators with back-bending (Z-conveyors) **hold down devices** are used to keep the belt down when it is changing from horizontal to inclined direction. For wide belts (e. g. > 800 mm (31.5") wide) slider shoes on the belt edge are often not sufficient to keep it on the track. In such cases hold down devices on the bottom side of the belt are used to guide it through the back-bending curve.

Compatibility: The hold down device can be put into any M5000 HabasitLINK® modular belt. The modules are inserted into the prepared position, one module every second row. As long as link steps are respected, any position over the belt width is possible.

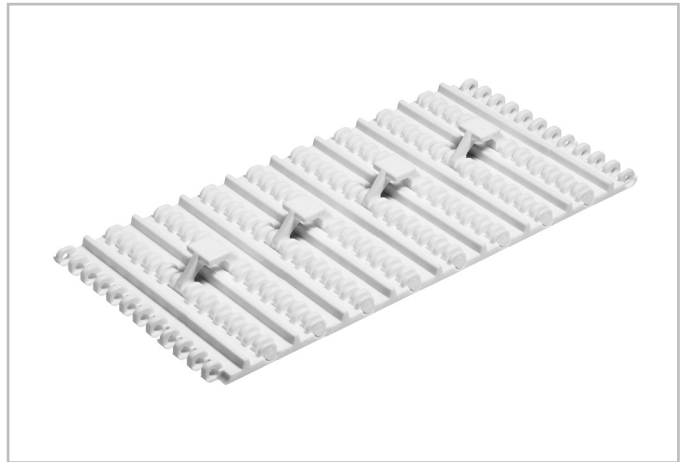

M5000V01

For a center positioning consider an offset "e" of 4.8 mm. Allow the necessary distance for the sprocket engagement!

Back-bending radius R: min. 250 mm (10")

Sprockets: minimum size M50S0840Q (8teeth) and M50S1060Q (10 teeth)

Standard materials: POM white
other materials possible on request.

Compatible belts series: M5010, M5020, M5030

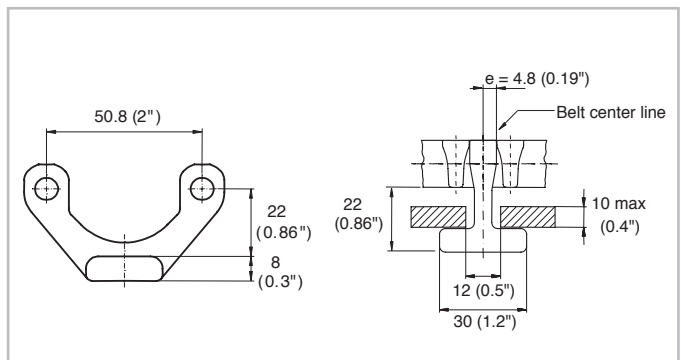

M5060V05

The tab module M5060V05 is designed as 2" mid module to be brick layed as a regular module. The length of two link indents give stability to the tab. This module can not be used as edge module.

Back-bending radius R: min. 250 mm (10")

Sprockets: minimum size 8 teeth (M50S08)

Standard materials: POM white other materials possible on request.

Compatible belts series: only M5060

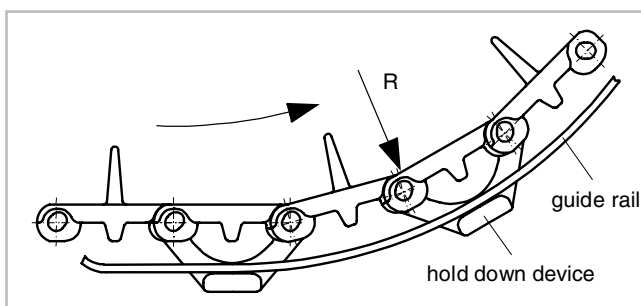
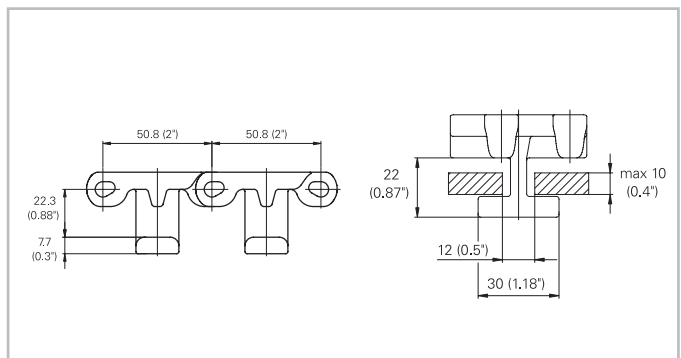

It is very important that the guide rail is very smooth, without joining. It is also important that enough clearance is provided to allow the belt to expand or shrink.