

# Inclined T-shape Cleats E-PT-R



## Main applications

Transversally applied on the belt, the profile assists secure product movement in inclined and declined applications. Mainly used in the food processing industry for bulk material transport.

## Description

Slanted T-profile used as a cleat on PVC conveyor and processing belts. Profiles are applied to the belt surface using a hot air or high frequency welding procedure.

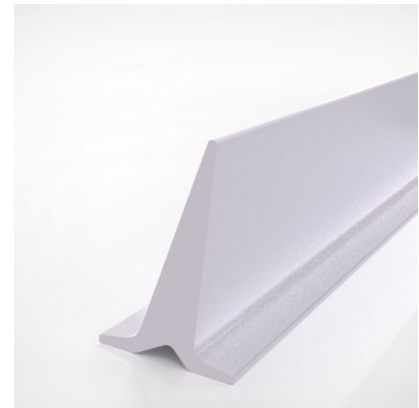

## Product data

Technical data	
Material type	PVC
Hardness	65 ShA

Code	Item number	Color	Food grade	DoC Name	Width	Height	Package	Quantity	Units	Box Content	Weight
					mm	mm					kg
E-PT40-RC-B60	H950019715	Cobalt blue	Yes	RC	30.0	40.0	Box	60	M	25 bars	0.4
E-PT70-RW-B24	H090034814	White	Yes	RW	40.0	70.0	Box	24	M	10 bars	0.9
E-PT20-RW-B156	H090060070	White	Yes	RW	20.0	20.0	Box	156	M	65 bars	0.144
E-PT30-RC-B72	H090034820	Cobalt blue	Yes	RC	30.0	30.0	Box	72	M	30 bars	0.283
E-PT30-RD-B72	H090060108	Dark green	Yes	RD	30.0	30.0	Box	72	M	30 bars	0.283
E-PT30-RW-B72	H090060071	White	Yes	RW	30.0	30.0	Box	72	M	30 bars	0.283
E-PT40-RW-B60	H090060072	White	Yes	RW	30.0	40.0	Box	60	M	25 bars	0.4
E-PT50-RC-B36	H090034821	Cobalt blue	Yes	RC	35.0	50.0	Box	36	M	15 bars	0.6
E-PT50-RD-B36	H090060109	Dark green	Yes	RD	35.0	50.0	Box	36	M	15 bars	0.6
E-PT50-RW-B36	H090034813	White	Yes	RW	35.0	50.0	Box	36	M	15 bars	0.6
E-PT70-RC-B24	H090034822	Cobalt blue	Yes	RC	40.0	70.0	Box	24	M	10 bars	0.9
E-PT70-RD-B24	H090060110	Dark green	Yes	RD	40.0	70.0	Box	24	M	10 bars	0.9

All data are approximate values under standard climatic conditions: 23°C/73°F, 50% relative humidity (DIN 50005/ISO 554). Limited representative testing based on a standard configuration is carried out to estimate minimum pulley diameters. Please contact Habasit for specific guidance regarding non-standard applications, including, but not exclusively, when profiles or cleats are used, or if the belt working temperature is close to the limits listed in this document.

Code	Minimum pulley dia. conveying side transversal
	mm
E-PT40-RC-B60	100
E-PT70-RW-B24	150
E-PT20-RW-B156	90
E-PT30-RC-B72	100
E-PT30-RD-B72	100
E-PT30-RW-B72	100
E-PT40-RW-B60	100
E-PT50-RC-B36	120
E-PT50-RD-B36	120
E-PT50-RW-B36	120
E-PT70-RC-B24	150
E-PT70-RD-B24	150

## Chemical resistance

Link to 'Chemical resistance information': <https://rims.habasit.com>

## Recommendation

General dimensional tolerance:  $\pm 3\%$  or  $\pm 0.20$  mm (whichever is greater).

## Disclaimer

### Product Application Disclaimer (valid for ALL Habasit products and mentioned on all PDS)

This disclaimer is made by and on behalf of Habasit and its affiliated companies, directors, employees, agents and contractors (hereinafter collectively "HABASIT") with respect to the products referred to herein (the "Products"). SAFETY WARNINGS SHOULD BE READ CAREFULLY AND ANY RECOMMENDED SAFETY PRECAUTIONS BE FOLLOWED STRICTLY! Please refer to the Safety Warnings herein, in the Habasit catalogue as well as installation and operating manuals. All indications / information as to the application, use and performance of the Products are recommendations provided with due diligence and care, but no representations or warranties of any kind are made as to their completeness, accuracy or suitability for a particular purpose. The data provided herein are based on laboratory application with small-scale test equipment, running at standard conditions, and do not necessarily match product performance in industrial use. New knowledge and experience may lead to re-assessments and modifications within a short period of time and without prior notice.

EXCEPT AS EXPLICITLY WARRANTED BY HABASIT, WHICH WARRANTIES ARE EXCLUSIVE AND IN LIEU OF ALL OTHER WARRANTIES, EXPRESS OR IMPLIED, THE PRODUCTS ARE PROVIDED "AS IS". HABASIT DISCLAIMS ALL OTHER WARRANTIES, EITHER EXPRESS OR IMPLIED, INCLUDING, BUT NOT LIMITED TO, IMPLIED WARRANTIES OF MERCHANTABILITY, FITNESS FOR A PARTICULAR PURPOSE, NON-INFRINGEMENT, OR ARISING FROM A COURSE OF DEALING, USAGE, OR TRADE PRACTICE, ALL OF WHICH ARE HEREBY EXCLUDED TO THE EXTENT ALLOWED BY APPLICABLE LAW. BECAUSE CONDITIONS OF USE IN INDUSTRIAL APPLICATION ARE OUTSIDE OF HABASIT'S CONTROL, HABASIT DOES NOT ASSUME ANY LIABILITY CONCERNING THE SUITABILITY AND PROCESS ABILITY OF THE PRODUCTS, INCLUDING INDICATIONS ON PROCESS RESULTS AND OUTPUT.